



Allura

A collection of fixtures with different facias to provide a wide variety of aesthetics to choose from, powered with 3 light engine options. Neo is an innovative versatile set of deep recessed anti-glare family of fixtures with a variety of optics and reflector finish options





Project - Hotel Planet Hollywood
Mumbai, India

Allura - Features

3 Lights Engines

Common light engines which can be used with any facia for different light output



2 Sizes

An option to choose from 2 different sizes of the same fixture based on application

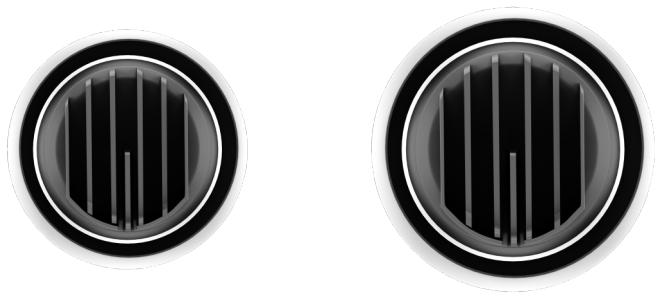

Ceiling Protection Ring

The detachable mounting ring provides ceiling protection in the long run



3 Filter Options

Multiple filter options are available. They can be added as separate fixture accessories

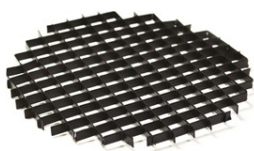

Honeycomb



Softening Lens



Diffusion Lens

Multiple Facias - Numerous Possibilities



Aperture Fix



Aperture Accent



Pinhole

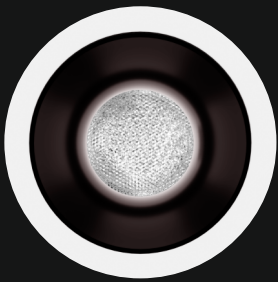

Fix



Tilt

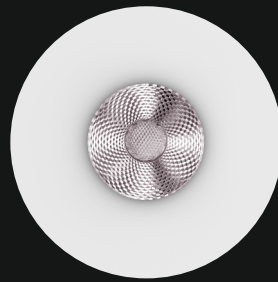

Taper

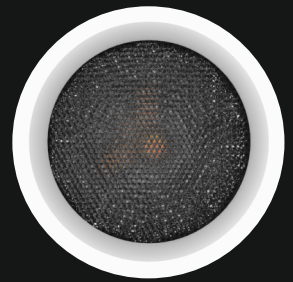

Mini



Round

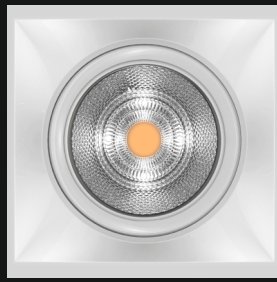

Square



Deep

Allura

LED Array 2 Step MacAdam L90-B10 60,000Hrs	Typ CRI 95	Trim Finish Matt White Matt Black	Interior Finish Matt Black	IP Rating IP44	Dimming Options Non Dim Triac Analog Dali Dali Tunable RF Tunable	Filter Options Diffusion Lens Softening Lens Honeycomb
---	---------------	---	-------------------------------	-------------------	---	---

Allura Aperture Fix

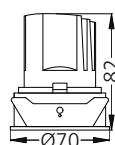
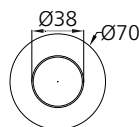

Ø65

Aperture Fix S
#1001

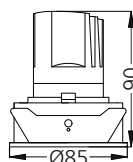
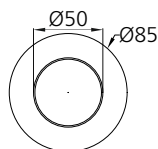

Ø77

Aperture Fix M
#1002

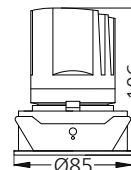
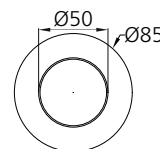

Ø77

Aperture Fix L
#1003

Power	7W/10W - 190mA/250mA	10W - 250mA	15W - 350mA
Lumen / CCT	580lm/835lm - 2700K 595lm/855lm - 3000K 610lm/880lm - 4000K Tunable White	835lm - 2700K 855lm - 3000K 880lm - 4000K Tunable White	1255lm - 2700K 1286lm - 3000K 1325lm - 4000K Tunable White
UGR	<19	<19	<19
Beam Angle	15° 24° 38°	10° 15° 24° 38° 60°	10° 15° 24° 38° 60°
Driver Placement	Remote	Remote	Remote

Allura

LED	Typ CRI	Trim Finish	Interior Finish	IP Rating	Dimming Options	Filter Options
Array 2 Step MacAdam L90-B10 60,000Hrs	95	Matt White Matt Black	Matt Black	IP44	Non Dim Triac Analog Dali Dali Tunable RF Tunable	Diffusion Lens Softening Lens Honeycomb

Allura Aperture Accent



Tilt & Rotate

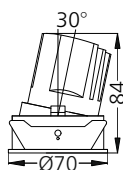
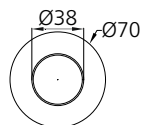

Ø65

Aperture Accent S
#1004

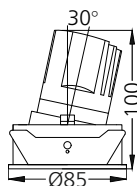
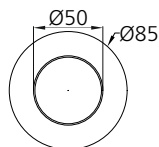

Ø77

Aperture Accent M
#1005

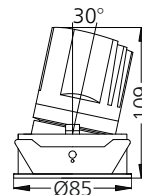
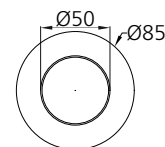

Ø77

Aperture Accent L
#1006

Power	7W/10W - 190mA/250mA
Lumen / CCT	580lm/835lm - 2700K 595lm/855lm - 3000K 610lm/880lm - 4000K Tunable White
UGR	<19
Beam Angle	15° 24° 38°
Driver Placement	Remote

Power	10W - 250mA
Lumen / CCT	835lm - 2700K 855lm - 3000K 880lm - 4000K Tunable White
UGR	<19
Beam Angle	10° 15° 24° 38° 60°
Driver Placement	Remote

Power	15W - 350mA
Lumen / CCT	1255lm - 2700K 1286lm - 3000K 1325lm - 4000K Tunable White
UGR	<19
Beam Angle	10° 15° 24° 38° 60°
Driver Placement	Remote

Allura

LED Array 2 Step MacAdam L90-B10 60,000Hrs	Typ CRI 95	Trim Finish Matt White Matt Black	Interior Finish Matt Black	IP Rating IP44	Dimming Options Non Dim Triac Analog Dali Dali Tunable RF Tunable	Filter Options Diffusion Lens Softening Lens Honeycomb
--	----------------------	--	--------------------------------------	--------------------------	--	--

Allura Pinhole



Tilt & Rotate

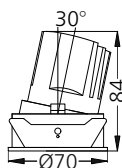
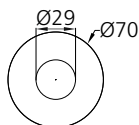

Ø65

Pinhole S
#1007

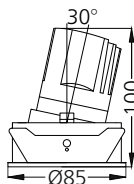
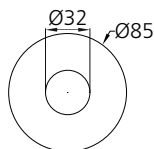

Ø77

Pinhole M
#1008

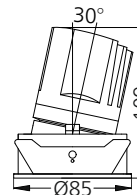
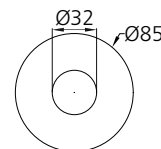
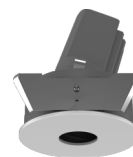

Ø77

Pinhole L
#1009

Power	7W/10W - 190mA/250mA	10W - 250mA	15W - 350mA
Lumen / CCT	485lm/685lm - 2700K 500lm/705lm - 3000K 515lm/725lm - 4000K Tunable White	685lm - 2700K 705lm - 3000K 725lm - 4000K Tunable White	1030lm - 2700K 1055lm - 3000K 1090lm - 4000K Tunable White
UGR	<19	<19	<19
Beam Angle	15° 24° 38°	10° 15° 24° 38° 60°	10° 15° 24° 38° 60°
Driver Placement	Remote	Remote	Remote

Allura

LED	Typ CRI	Trim Finish	Interior Finish	IP Rating	Dimming Options	Filter Options
Array 2 Step MacAdam L90-B10 60,000Hrs	95	Matt White Matt Black	Matt White Matt Black Specular Pearl Black Matt Silver Matt Gold	IP44	Non Dim Triac Analog Dali Dali Tunable RF Tunable	Diffusion Lens Softening Lens Honeycomb

Allura Fix

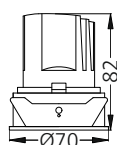
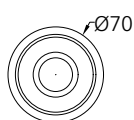

Ø65

Fix S
#1013

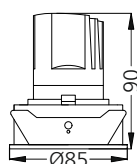
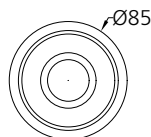

Ø77

Fix M
#1014

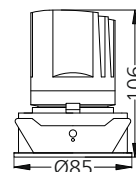
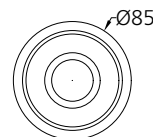

Ø77

Fix L
#1015

Power	7W/10W - 190mA/250mA	10W - 250mA	15W - 350mA
Lumen / CCT	610lm/880lm - 2700K 625lm/900lm - 3000K 645lm/930lm - 4000K Tunable White	880lm - 2700K 900lm - 3000K 930lm - 4000K Tunable White	1320lm - 2700K 1355lm - 3000K 1400lm - 4000K Tunable White
UGR	<19	<19	<19
Beam Angle	15° 24° 38°	10° 15° 24° 38° 60°	10° 15° 24° 38° 60°
Driver	Remote	Remote	Remote
Placement			

Allura

LED	Typ CRI	Trim Finish	Interior Finish	IP Rating	Dimming Options	Filter Options
Array 2 Step MacAdam L90-B10 60,000Hrs	95	Matt White Matt Black	Matt White Matt Black Specular Pearl Black Matt Silver Matt Gold	IP44	Non Dim Triac Analog Dali Dali Tunable RF Tunable	Diffusion Lens Softening Lens Honeycomb

Allura Tilt



Tilt & Rotate

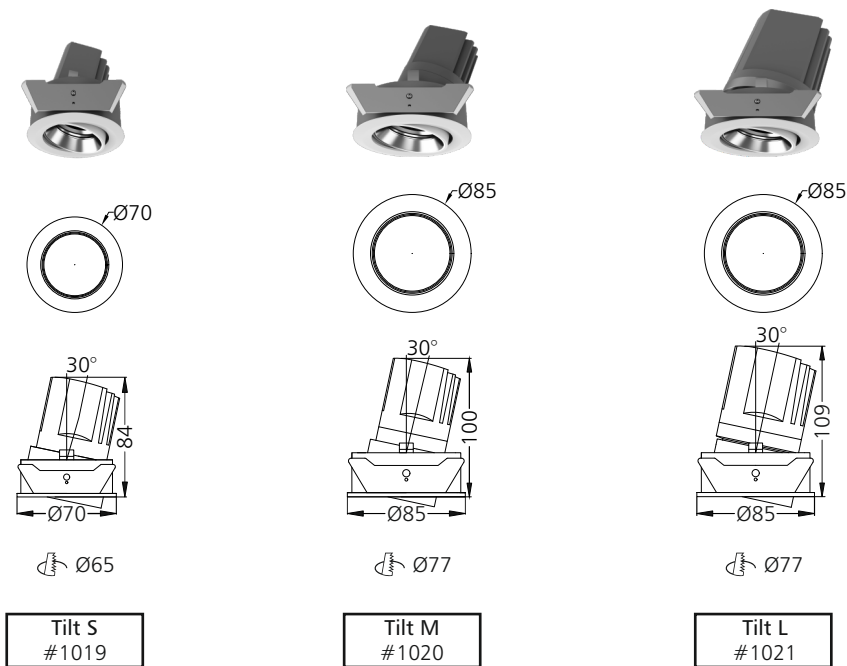

Power	7W/10W - 190mA/250mA	10W - 250mA	15W - 350mA
Lumen / CCT	610lm/880lm - 2700K 625lm/900lm - 3000K 645lm/930lm - 4000K Tunable White	880lm - 2700K 900lm - 3000K 930lm - 4000K Tunable White	1320lm - 2700K 1355lm - 3000K 1400lm - 4000K Tunable White
UGR	<19	<19	<19
Beam Angle	15° 24° 38°	10° 15° 24° 38° 60°	10° 15° 24° 38° 60°
Driver Placement	Remote	Remote	Remote

Allura

LED Array 2 Step MacAdam L90-B10 60,000Hrs	Typ CRI 95	Trim Finish Matt White Matt Black	Interior Finish Matt White	IP Rating IP44	Dimming Options Non Dim Triac Analog Dali Dali Tunable RF Tunable	Filter Options Diffusion Lens Softening Lens Honeycomb
--	----------------------	--	--------------------------------------	--------------------------	--	--

Allura Taper

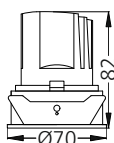
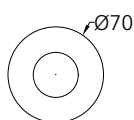

Ø65

Taper S
#1037

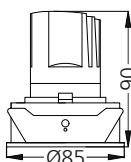
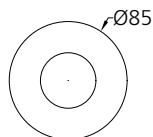

Ø77

Taper M
#1038

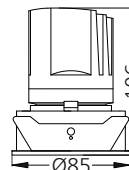
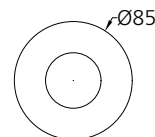

Ø77

Taper L
#1039

Power	7W/10W - 190mA/250mA	10W - 250mA	15W - 350mA
Lumen / CCT	585lm/835lm - 2700K 600lm/855lm - 3000K 620lm/880lm - 4000K Tunable White	835lm - 2700K 855lm - 3000K 880lm - 4000K Tunable White	1250lm - 2700K 1280lm - 3000K 1320lm - 4000K Tunable White
UGR	<19	<19	<19
Beam Angle	15° 24° 38°	10° 15° 24° 38° 60°	10° 15° 24° 38° 60°
Driver Placement	Remote	Remote	Remote

Allura

LED Array 2 Step MacAdam L90-B10 60,000Hrs	Typ CRI 95	Trim Finish Matt White Matt Black	Interior Finish Matt White	IP Rating IP44	Dimming Options Non Dim Triac Analog Dali Dali Tunable RF Tunable	Filter Options Diffusion Lens Softening Lens Honeycomb
--	----------------------	--	--------------------------------------	--------------------------	--	--

Allura Mini

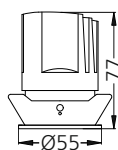
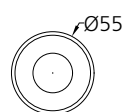

Ø50

Mini S
#1043

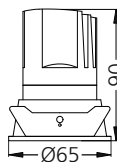
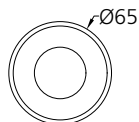

Ø60

Mini M
#1044

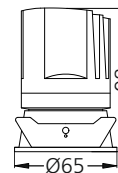
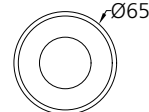

Ø60

Mini L
#1045

Power	7W/10W - 190mA/250mA	10W - 250mA	15W - 350mA
Lumen / CCT	545lm/780lm - 2700K 560lm/800lm - 3000K 580lm/825lm - 4000K Tunable White	780lm - 2700K 800lm - 3000K 825lm - 4000K Tunable White	1170lm - 2700K 1200lm - 3000K 1235lm - 4000K Tunable White
UGR	<19	<19	<19
Beam Angle	15° 24° 38°	10° 15° 24° 38° 60°	10° 15° 24° 38° 60°
Driver Placement	Remote	Remote	Remote

Allura

LED	Typ CRI	Trim Finish	Interior Finish	IP Rating	Dimming Options	Filter Options
Array 2 Step MacAdam L90-B10 60,000Hrs	95	Matt White Matt Black	Matt White	IP44	Non Dim Triac Analog Dali Dali Tunable RF Tunable	Diffusion Lens Softening Lens Honeycomb



Tilt & Rotate

Allura Round

Allura Square

Allura Deep

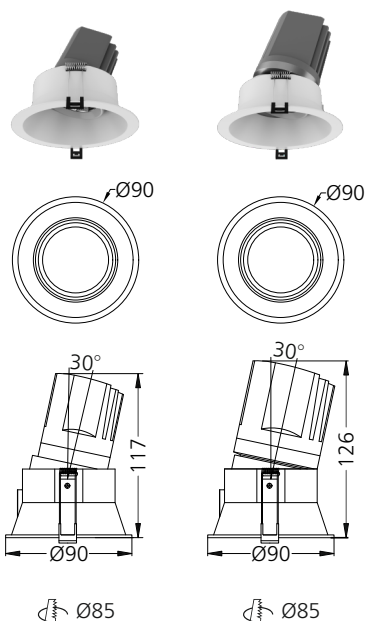

Round M
#1046

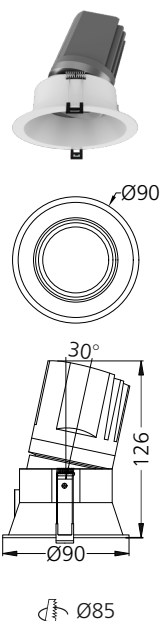

Round L
#1047

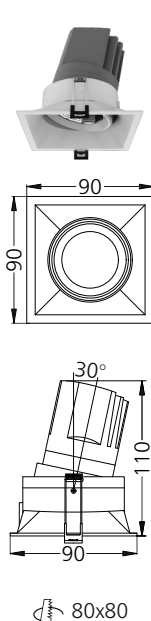

Square M
#1048

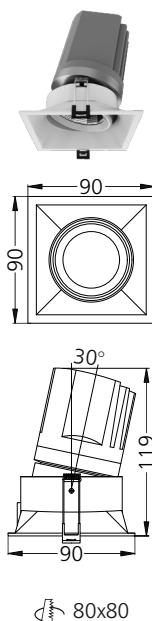

Square L
#1049

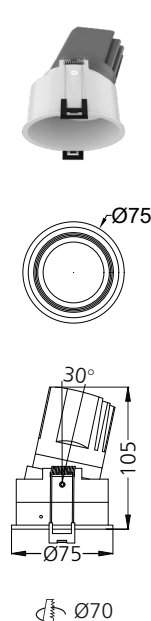

Deep M
#1050

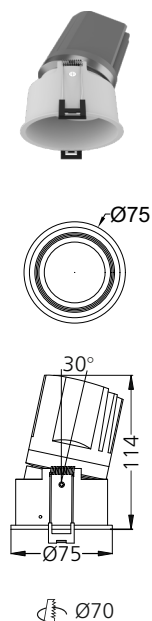

Deep L
#1051

	Round M / Square M / Deep M	Round L / Square L / Deep L
Power	10W - 250mA	15W - 350mA
Lumen / CCT	810lm - 2700K 830lm - 3000K 855lm - 4000K Tunable White	1215lm - 2700K 1245lm - 3000K 1285lm - 4000K Tunable White
UGR	<19	<19
Beam Angle	10° 15° 24° 38° 60°	10° 15° 24° 38° 60°
Driver Placement	Remote	Remote



Item	Price
Hot Coffee	...
Coffee	...
Tea	...
Blended Breads	...
Starbucks Beans	...

FLAVORS OF THE SEASON



Starbucks Caramel Macchiato
Starbucks Caramel Macchiato

SOFTLY GOOD



Starbucks Soft Drink
Starbucks Soft Drink

SERVING INDULGENCE



Starbucks Frappuccino
Starbucks Frappuccino

RE-DISCOVER Your Favorites



Starbucks Coffee
Starbucks Coffee

Project - Starbucks Stores Pan India

Allura Neo - Features

Multiple size options

Build your fixture by choosing from 3 different diameters and 9 separate light engines

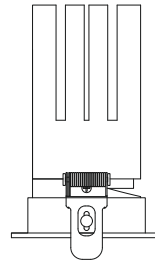
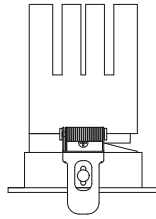
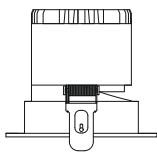
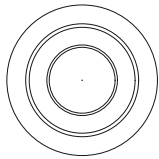

Trim diameter - 64mm
Light Engine 1 - 55mm
Light Engine 2 - 80mm
Light Engine 3 - 100mm

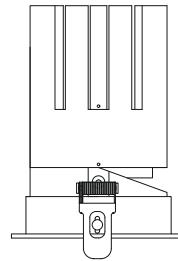
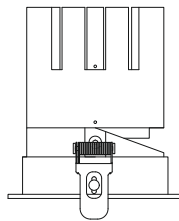
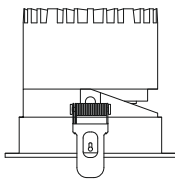
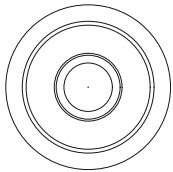

Trim diameter - 84mm
Light Engine 1 - 74mm
Light Engine 2 - 92mm
Light Engine 3 - 112mm

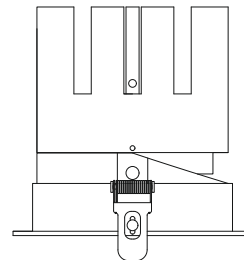
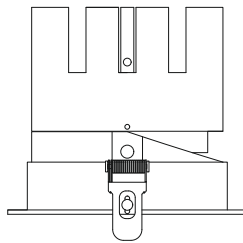
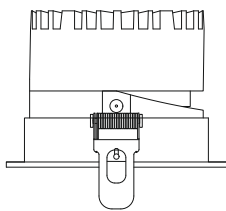
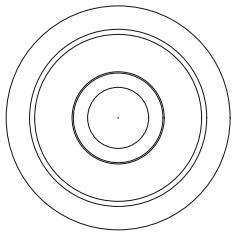

Trim diameter - 110mm
Light Engine 1 - 78mm
Light Engine 2 - 95mm
Light Engine 3 - 105mm

Lighting Effect with 38° optic

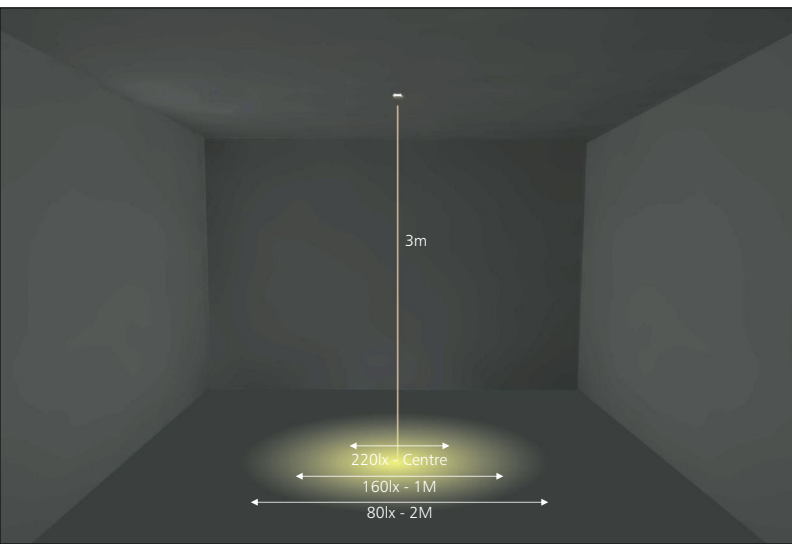

Glare cut off angle

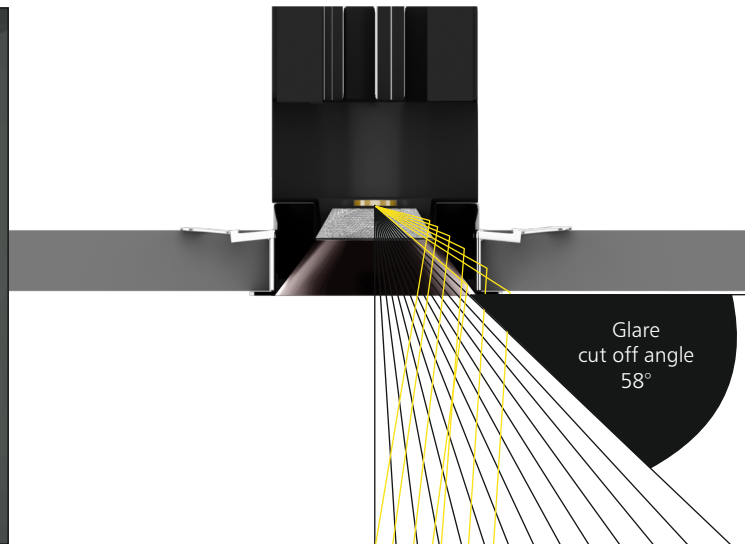



Metallised & Matt reflector finishes available in the entire range of Allura Neo

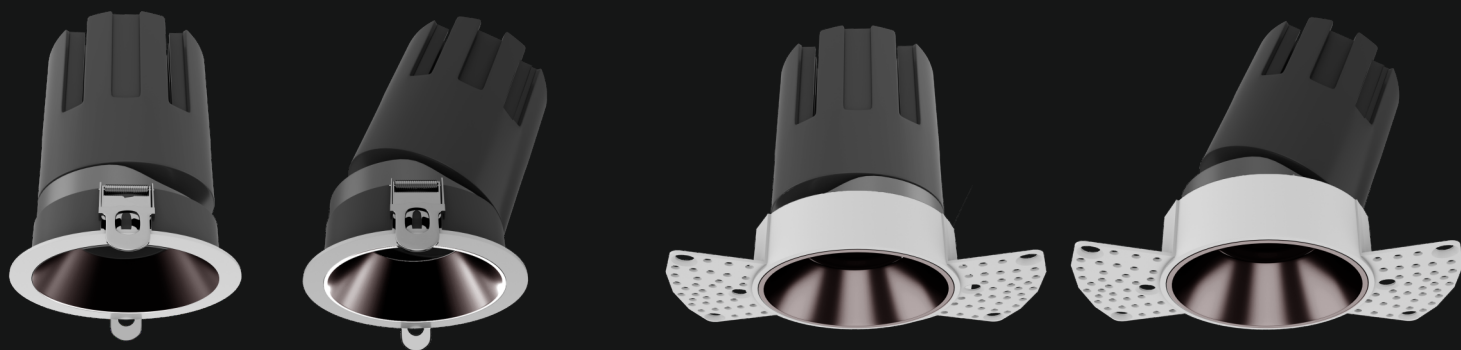

Fixed & Tilt+Rotate versions

Trimless mounting versions

Ceiling protection with
Pull & Replace mechanism

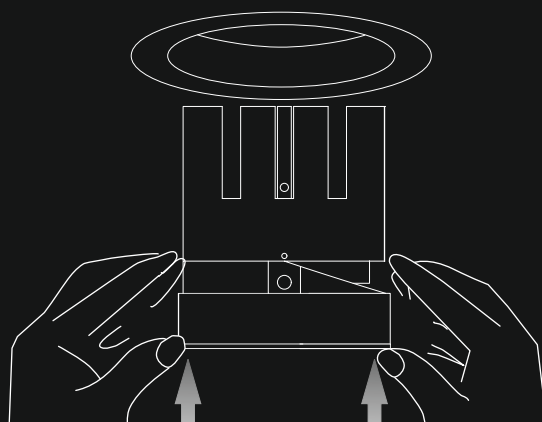



Project - Taj Skyline Hotel
Ahmedabad, India

Allura Neo

LED	Typ CRI	Trim Finish	Reflector Finish	IP Rating	Dimming Options	Filter Options
Array 2 Step MacAdam L90-B10 60,000Hrs	95	Matt White Matt Black	Matt White Matt Black Specular Pearl Black Matt Silver Matt Gold	IP44	Non Dim Triac Analog Dali Dali Tunable RF Tunable	Honeycomb

Allura Neo (Trim / Trimless)



Neo SF - 1
#1422



Neo SF - 2
#1423



Neo SF - 3
#1424



Neo SF - 1
#1425



Neo SF - 2
#1426

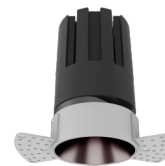

Neo SF - 3
#1427

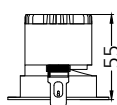
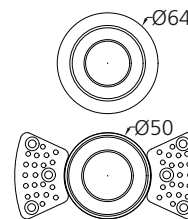
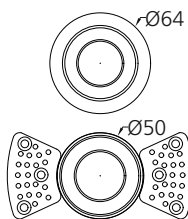
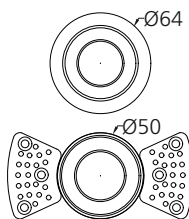

Ø55

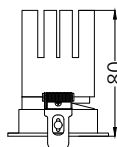

Ø55

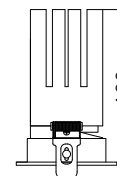

Ø55

Power	7W - 190mA	10W - 250mA	12W - 300mA
Lumen / CCT	595lm - 2700K 610lm - 3000K 630lm - 4000K Tunable White	850lm - 2700K 870lm - 3000K 900lm - 4000K Tunable White	1020lm - 2700K 1045lm - 3000K 1080lm - 4000K Tunable White
UGR	<16	<16	<16
Beam Angle	15° 24° 38° 60°	15° 24° 38° 60°	15° 24° 38° 60°
Driver Placement	Remote	Remote	Remote

Allura Neo

LED	Typ CRI	Trim Finish	Reflector Finish	IP Rating	Dimming Options	Filter Options
Array 2 Step MacAdam L90-B10 60,000Hrs	95	Matt White Matt Black	Matt White Matt Black Specular Pearl Black Matt Silver Matt Gold	IP44	Non Dim Triac Analog Dali Dali Tunable RF Tunable	Honeycomb

Allura Neo (Trim / Trimless)



Tilt & Rotate



Neo SA- 1
#1428



Neo SA- 2
#1429



Neo SA- 3
#1430



Neo SA- 1
#1431



Neo SA- 2
#1432

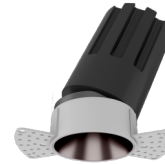

Neo SA- 3
#1433

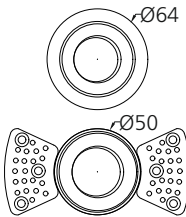

Ø55

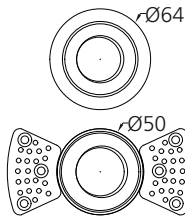

Ø55

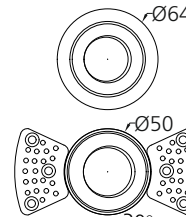

Ø55

Power	7W - 190mA	10W - 250mA	12W - 300mA
Lumen / CCT	595lm - 2700K 610lm - 3000K 630lm - 4000K Tunable White	850lm - 2700K 870lm - 3000K 900lm - 4000K Tunable White	1020lm - 2700K 1045lm - 3000K 1080lm - 4000K Tunable White
UGR	<16	<16	<16
Beam Angle	15° 24° 38° 60°	15° 24° 38° 60°	15° 24° 38° 60°
Driver Placement	Remote	Remote	Remote

Allura Neo

LED	Typ CRI	Trim Finish	Reflector Finish	IP Rating	Dimming Options	Filter Options
Array 2 Step MacAdam L90-B10 60,000Hrs	95	Matt White Matt Black	Matt White Matt Black Specular Pearl Black Matt Silver Matt Gold	IP44	Non Dim Triac Analog Dali Dali Tunable RF Tunable	Honeycomb

Allura Neo (Trim / Trimless)



Neo MF - 1
#1434



Neo MF - 2
#1435



Neo MF - 3
#1436

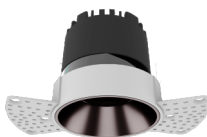

Neo MF - 1
#1437



Neo MF - 2
#1438



Neo MF - 3
#1439

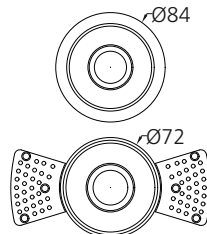

Ø75

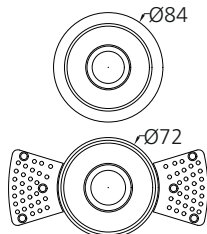

Ø75

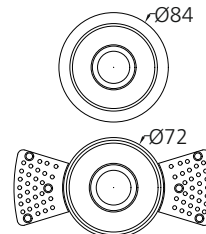

Ø75

Power	12W - 300mA	15W - 350mA	20W - 500mA
Lumen / CCT	1020lm - 2700K 1045lm - 3000K 1080lm - 4000K Tunable White	1275lm - 2700K 1305lm - 3000K 1350lm - 4000K Tunable White	1700lm - 2700K 1740lm - 3000K 1800lm - 4000K Tunable White
UGR	<16	<16	<16
Beam Angle	15° 24° 38° 60°	15° 24° 38° 60°	15° 24° 38° 60°
Driver Placement	Remote	Remote	Remote

Allura Neo

LED	Typ CRI	Trim Finish	Reflector Finish	IP Rating	Dimming Options	Filter Options
Array 2 Step MacAdam L90-B10 60,000Hrs	95	Matt White Matt Black	Matt White Matt Black Specular Pearl Black Matt Silver Matt Gold	IP44	Non Dim Triac Analog Dali Dali Tunable RF Tunable	Honeycomb

Allura Neo (Trim / Trimless)

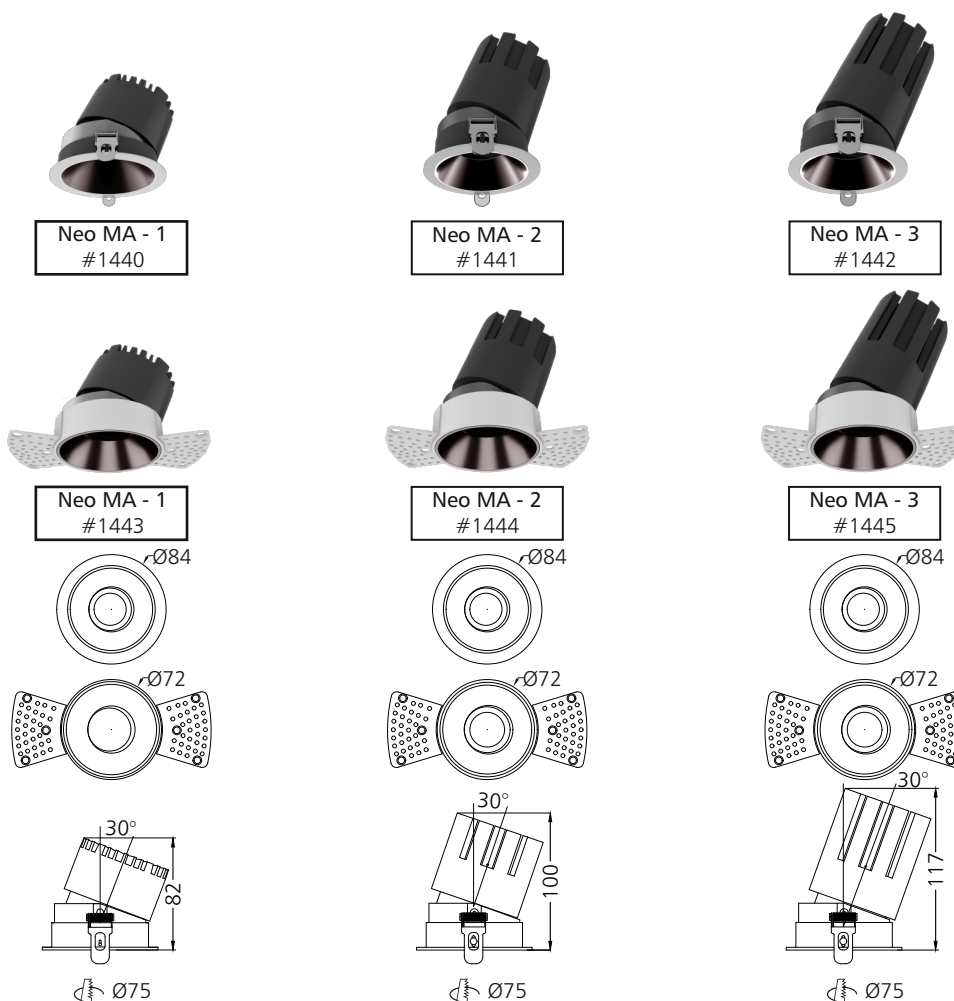

	Neo MA - 1 #1440	Neo MA - 2 #1441	Neo MA - 3 #1442
Power	12W - 300mA	15W - 350mA	20W - 500mA
Lumen / CCT	1020lm - 2700K 1045lm - 3000K 1080lm - 4000K Tunable White	1275lm - 2700K 1305lm - 3000K 1350lm - 4000K Tunable White	1700lm - 2700K 1740lm - 3000K 1800lm - 4000K Tunable White
UGR	<16	<16	<16
Beam Angle	15° 24° 38° 60°	15° 24° 38° 60°	15° 24° 38° 60°
Driver	Remote	Remote	Remote

Allura Neo

LED	Typ CRI	Trim Finish	Reflector Finish	IP Rating	Dimming Options	Filter Options
Array 2 Step MacAdam L90-B10 60,000Hrs	95	Matt White Matt Black	Matt White Matt Black Specular Pearl Black Matt Silver Matt Gold	IP44	Non Dim Triac Analog Dali Dali Tunable RF Tunable	Honeycomb

Allura Neo (Trim / Trimless)



Neo LF - 1
#1446



Neo LF - 2
#1447



Neo LF - 3
#1448

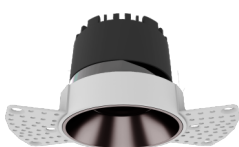

Neo LF - 1
#1449

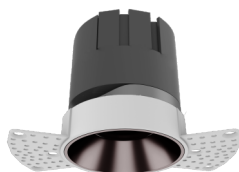

Neo LF - 2
#1450

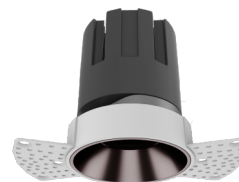

Neo LF - 3
#1451

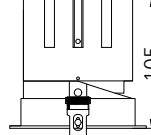
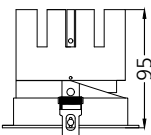
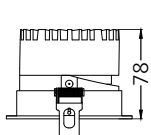
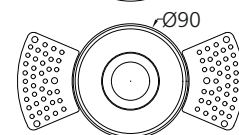
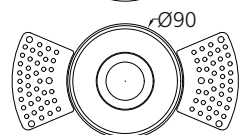
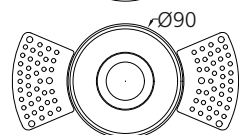
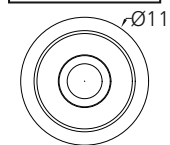
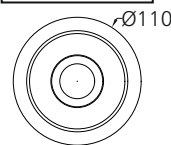
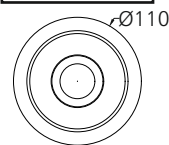

Power	20W - 500mA
Lumen / CCT	1700lm - 2700K 1740lm - 3000K 1800lm - 4000K Tunable White
UGR	<16
Beam Angle	15° 24° 38° 60°
Driver Placement	Remote

Power	25W - 600mA
Lumen / CCT	2125lm - 2700K 2175lm - 3000K 2250lm - 4000K Tunable White
UGR	<16
Beam Angle	15° 24° 38° 60°
Driver Placement	Remote

Power	30W - 750mA
Lumen / CCT	2550lm - 2700K 2610lm - 3000K 2700lm - 4000K Tunable White
UGR	<16
Beam Angle	15° 24° 38° 60°
Driver Placement	Remote

Allura Neo

LED	Typ CRI	Trim Finish	Reflector Finish	IP Rating	Dimming Options	Filter Options
Array 2 Step MacAdam L90-B10 60,000Hrs	95	Matt White Matt Black	Matt White Matt Black Specular Pearl Black Matt Silver Matt Gold	IP44	Non Dim Triac Analog Dali Dali Tunable RF Tunable	Honeycomb

Allura Neo (Trim / Trimless)



Tilt & Rotate



Neo LA - 1
#1452



Neo LA - 2
#1453



Neo LA - 3
#1454

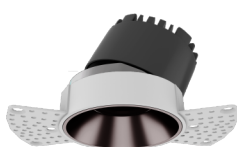

Neo LA - 1
#1455



Neo LA - 2
#1456

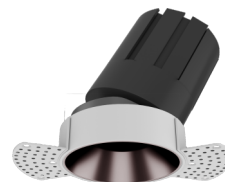

Neo LA - 3
#1457

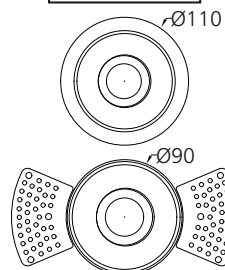
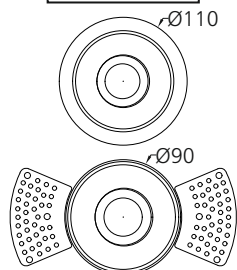
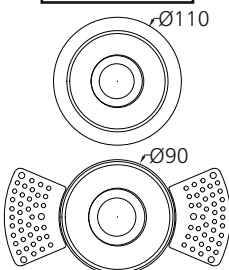

Power
Lumen / CCT

Ø100
20W - 500mA
1700lm - 2700K
1740lm - 3000K
1800lm - 4000K
Tunable White

UGR
Beam Angle

<16
15° 24°
38° 60°

Driver
Placement
www.lazurelighting.com

Remote

Power
Lumen / CCT

Ø100
25W - 600mA
2125lm - 2700K
2175lm - 3000K
2250lm - 4000K
Tunable White

UGR
Beam Angle

<16
15° 24°
38° 60°

Driver
Placement
www.lazurelighting.com

Remote

Power
Lumen / CCT

Ø100
30W - 750mA
2550lm - 2700K
2610lm - 3000K
2700lm - 4000K
Tunable White

UGR
Beam Angle

<16
15° 24°
38° 60°

Driver
Placement
www.lazurelighting.com

Remote